

Element de referinta

Schuco AWS 90.SI+

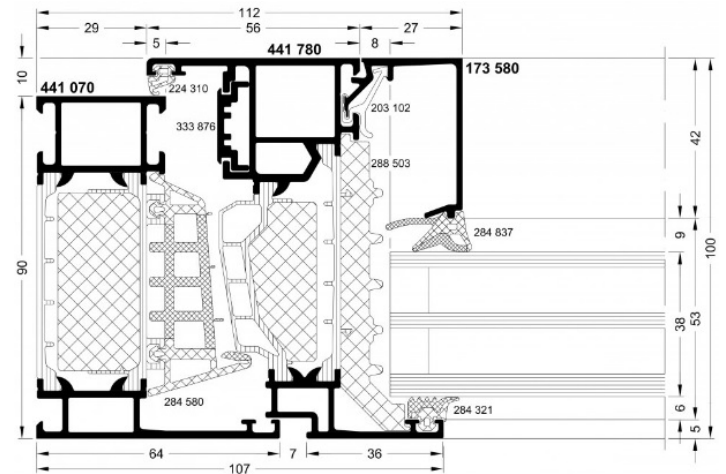
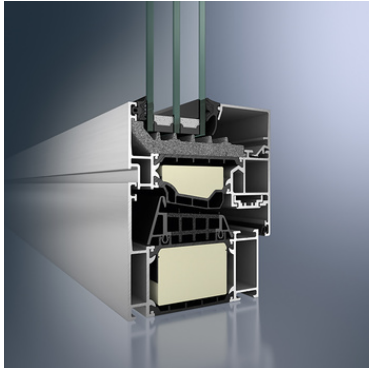

Dimensiuni minimale

Toc: **min. 90 mm**

Cercevea: **min. 100 mm**

Grosime minima a peretelui pentru profil de fereastră: **min. 1.6 mm**

Grosime minima a peretelui pentru profil de usa: **min. 2.0 mm**

Latime vizibila: **min. 107 mm**

Date tehnice de performanta

1. Profil din aluminiu din aliaj AlMgSi F22 conform *EN 755 T6-66, EN 12020*
2. Izolare termica **pana la $U_f = 0.7 \text{ W/m}^2\text{K}$** conform standard *DIN EN ISO 1077-2*
3. Izolare fonica **la cerere** conform standard *DIN EN ISO 140-3*
4. Rezistenta antiefractie **de la basic standard pana la clasa WK3 (RC3)** conform standard *DIN EN 1627* cu feronerie proprie
5. Etanseitate la apa **clasa 9a** conform standard *DIN EN 12208*
6. Etanseitate la aer **clasa 4** conform standard *DIN EN 12207*
7. Rezistenta la incarcare de vant **clasa C5/B5** conform standard *DIN 12210*
8. Incarcatura mecanica **clasa 4** conform standard *DIN EN 13115*
9. Functionalitate pe termen lung **clasa 3** conform standard *DIN EN 12400*
10. Feronerie *Schüco AvanTec* disponibila pana la **160 kg**
11. Feronerie *Schüco TipTronic* disponibila pana la **160 kg**